



© Any reproduction must include this copyright notice.

THELCO CUTAWAY DRAWING OF WORTHINGTON® TYPE CNG FRAME 1, 2, AND 3, OIL LUBE.

REFERENCE NUMBERS

REF #	DESCRIPTION
1	CASING
2	SHAFT
4	IMPELLER
6	THRUST BEARING
8	LINE BEARING
9	PACKING SET
13	SEAL CAGE
15	PACKING GLAND
16	IMPELLER NUT
19	THRUST BRG COVER
22	LINE BEARING SLINGER
22A	THRUST BRG SLINGER (GREASE LUBE)
22B	DRIP LIP
22C	DRIP PAN
23	LINE BEARING COVER
24A	BEARING LOCK NUT
27A	THRUST BRG LIP SEAL (OIL LUBE)
27B	LINE BRG LIP SEAL (OIL LUBE)
27C	SEAL RING THRST BRG COV
35	SUCTION HEAD
36	IMPELLER KEY
36B	COUPLING KEY
59	BEARING FRAME
60	OIL FLINGER
60A	COLLAR, FLINGER
73	VENT OR DRAIN PLUG
73B	SEAL PIPE PLUG
73F	PIPE PLUG
83S	STUD, GLAND
83N	NUT, GLAND STUD
91	SUCTION HEAD GASKET
91A	BEARING COVER GASKET
107	GREASE FTNG, FRAME
107B	GREASE FTNG, THRST BRG CVR
133	BRG SHIM, .005 OR .010
153	BOLT, CASING - FRAME
153A	BOLT, SUCTION HEAD - CASING
153B	BOLT, THRUST COVER
153D	BOLT, LINE COVER
185	CONSTANT LEVEL OILER
187	VENT CAP
207	IMPELLER LOCK WASHER
207A	BRG LOCK NUT WASHER

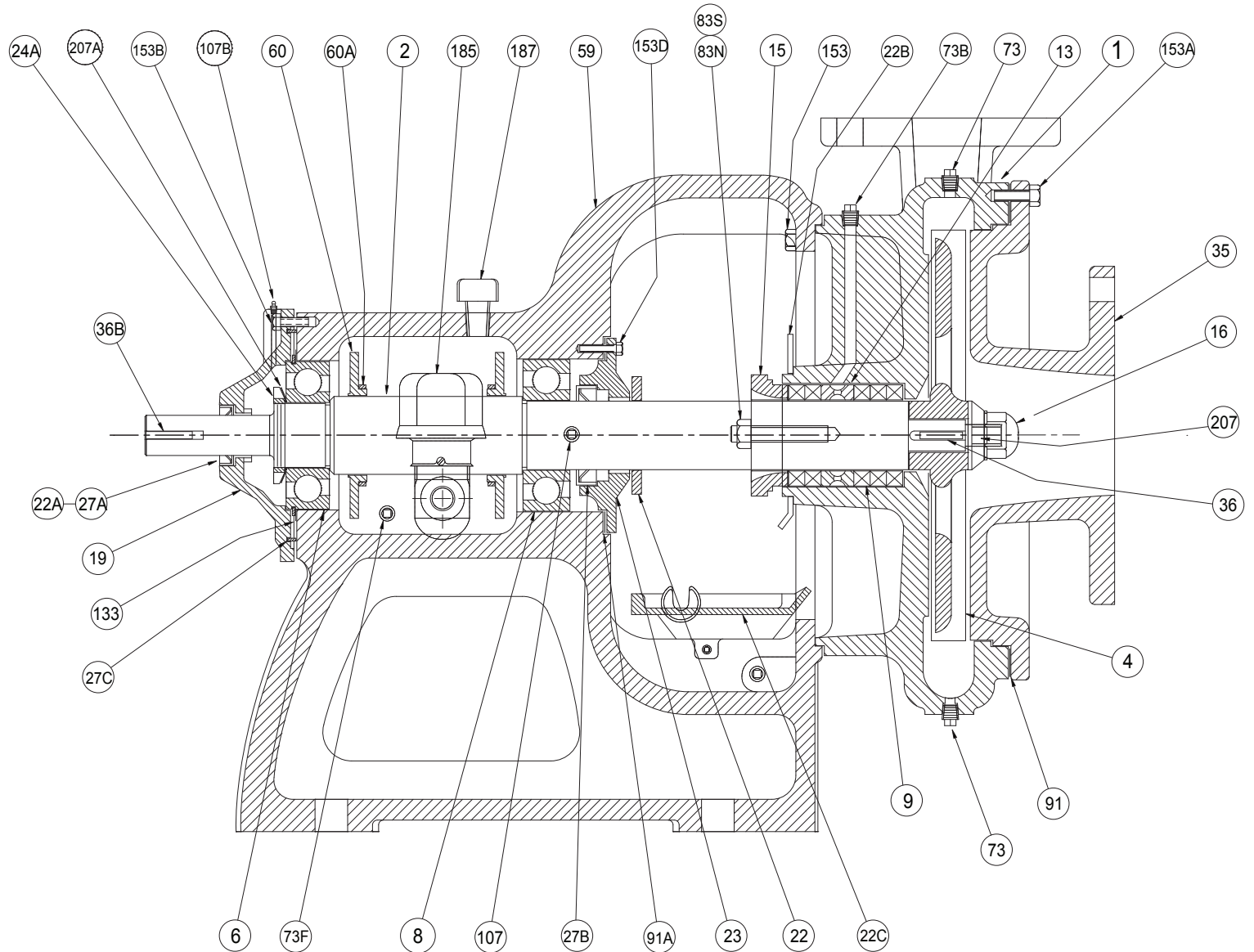

WORTHINGTON® is a registered trademark of Ingersoll-Dresser Pump Company.
Thelco is not affiliated with WORTHINGTON® or Ingersoll-Dresser Pump Company